



Communities,
Land and
Environment

Communautés,
Terres et
Environnement



Office of the Minister
PO Box 2000, Charlottetown
Prince Edward Island
Canada C1A 7N8

Bureau du ministre
C.P. 2000, Charlottetown
Île-du-Prince-Édouard
Canada C1A 7N8

April 4, 2019

Blaine Yatabe
Town of Stratford
234 Shakespeare Drive
Stratford PE
C1B 2V8

Dear Mr. Yatabe:

Re: Town of Stratford Official Plan and Zoning and Development Bylaw Amendments

I am pleased to advise that I have approved the following amendments concerning the Town of Stratford Official Plan and Zoning and Development Bylaw as follows:

Official Plan – Map Amendment

A portion of parcel #518910, #398610, #538132 and #482307 (approximately 1.3 acres) located on Dale Drive to be designated as Mixed Use on the Town of Stratford Official Plan Land Use Map excluding the former designation of Commercial.

Zoning and Development Bylaw – Map Amendment

A portion of parcel #518910, #398610, #538132 and #482307 (approximately 1.3 acres) located on Dale Drive to be designated as Mason Road mixed Use (MRMU) in Schedule "A" of the Zoning Map of the Town of Stratford Zoning and Development Bylaw #45, excluding the former designation of Commercial.

Please note that the effective date of these amendments is the date of my signature. I trust that these amendments provide for Stratford's continued commitment to orderly development. Thank you for Council's continued effort to ensure that present and future land use management goals of Stratford are protected through effective land use planning.

Yours truly,

Mary Lynn Kane, Q.C.
Deputy Minister of Communities, Land and Environment

Encl.

TOWN OF STRATFORD
OFFICIAL PLAN AMENDMENT OPA-1-2019
AN AMENDMENT TO THE TOWN OF STRATFORD OFFICIAL PLAN

Authority:

The Council for the Town of STRATFORD under the authority vested in it by Section 18 of the Planning Act R.S.P.E.I. 1988 Cap. P-8 hereby enacts as follows:

That a portion of PID 518910, 398610, 538132, and PID 482307 as shown on Appendix "A" - Land Use Map of the Town of STRATFORD Official Plan, are designated as Mixed Use, hereby excluding the former designation of Commercial.

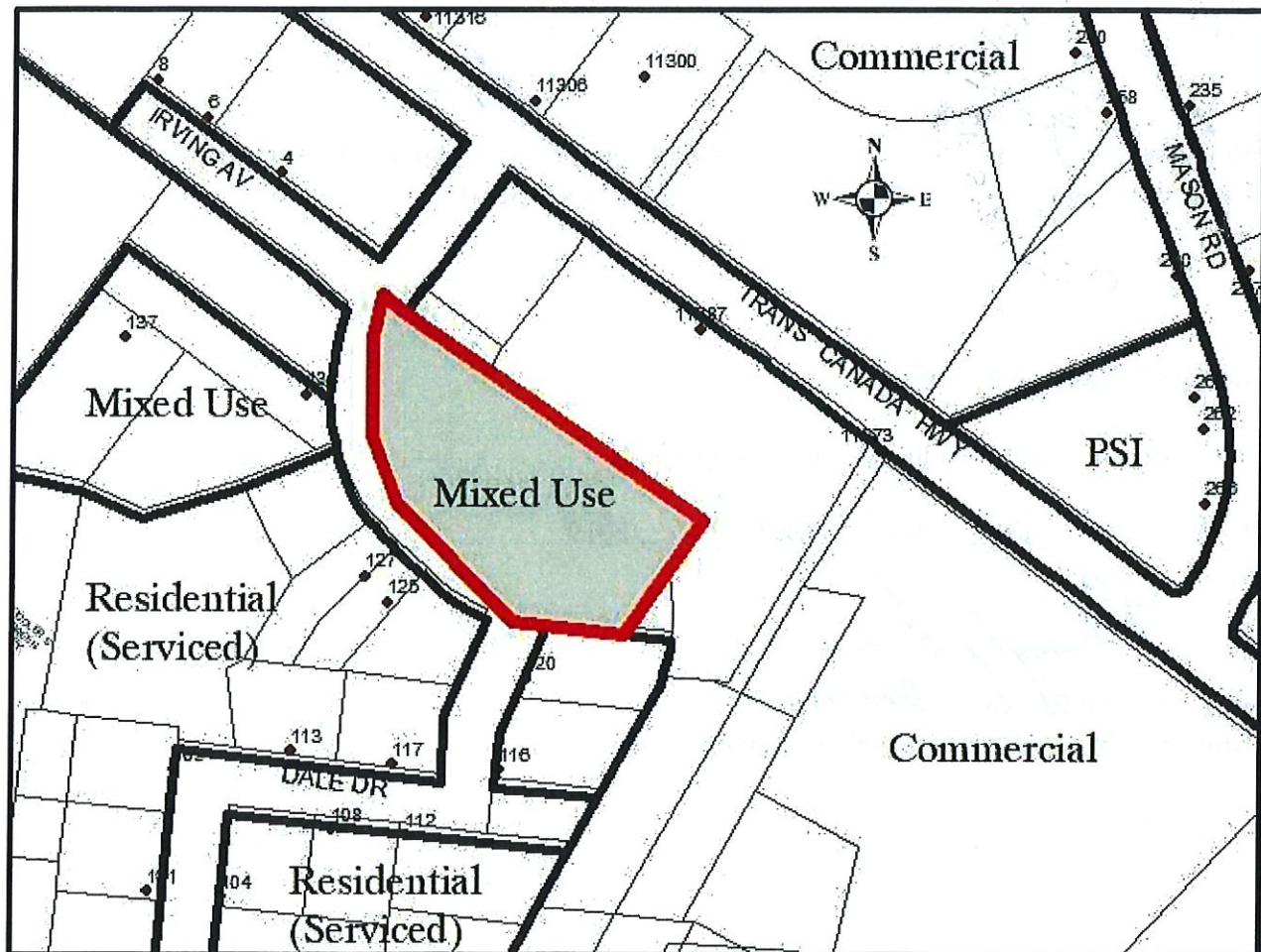

Effective Date:

The effective date of the Official Plan amendment is the date as signed below by the Minister of Communities, Land and Environment.

Adoption and Approval by Council:

The Official Plan amendment #OPA-1-2019 was adopted and approved by a majority of the Councillors present at the Council Meeting held on Jan, 9, 2019.



Steve Ogden, Mayor
(signature sealed)



Robert Hughes, Chief Administrative Officer
(signature sealed)

MINISTERIAL APPROVAL

This Official Plan Amendment is hereby approved.

Dated on this 8th day of April, 2019



Hon. Richard Brown

134 Minister of Communities, Land and Environment

TOWN OF STRATFORD

Zoning and Development Bylaw Amendment

Bylaw # 45-A

A Bylaw to amend the Town of Stratford Zoning and Development Bylaw, Bylaw #45 to change Schedule "A" Zoning Map

BE IT ENACTED that a portion of parcel numbers 518910, 398610, 538132, 482307, (approx. 1.3 acres) be hereby designated as Mason Road Mixed Use (MRMU) in Schedule "A" of the Zoning Map of the Town of Stratford Zoning and Development Bylaw #45, as shown on the attached map, hereby excluding it from its former designation of Mason Road Commercial (MRC).

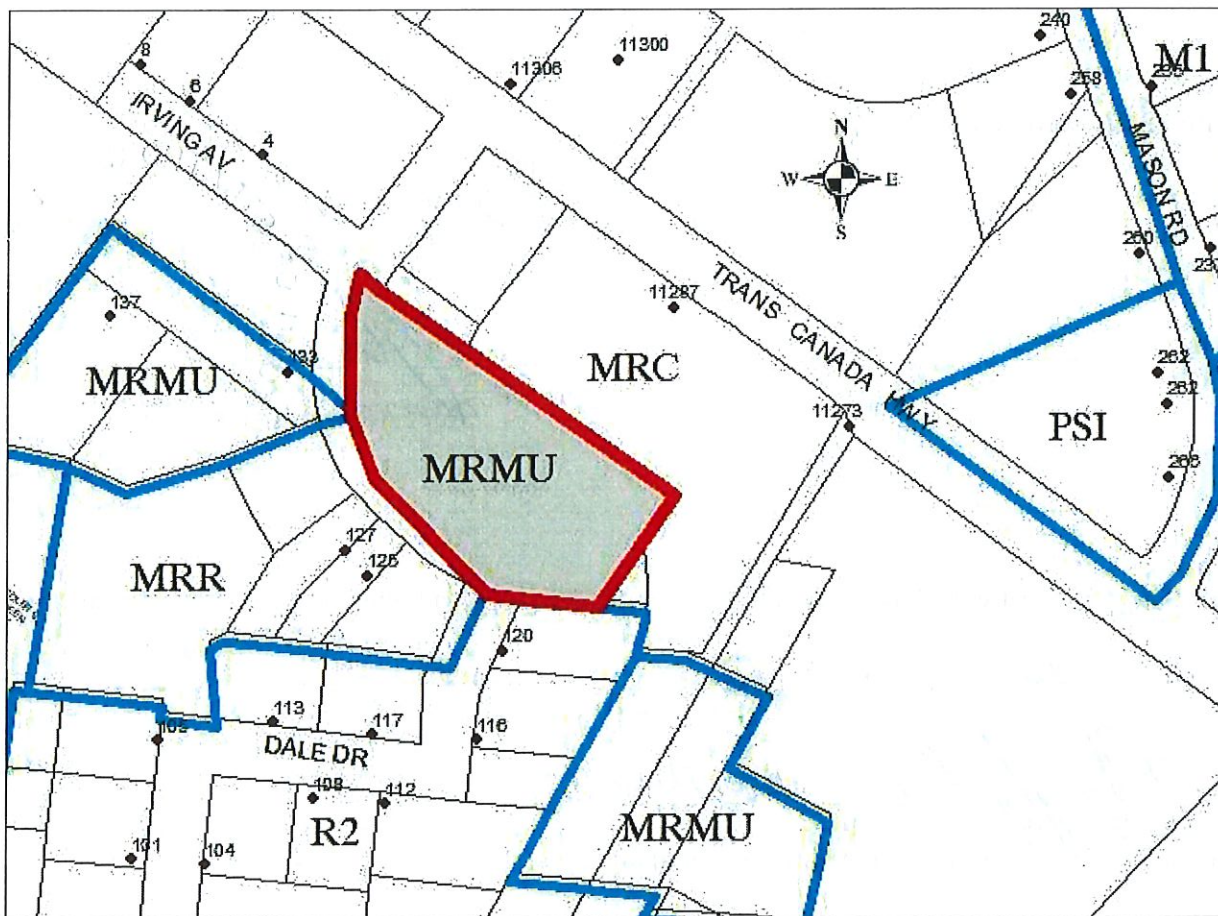

This Bylaw received first reading and formal approval at the Town Council meeting of January 9th, 2019.

This Bylaw received second reading and final approval at the Town Council meeting of February 20, 2019.

This bylaw was formally adopted by Council at a meeting held on February 20, 2019, 2019.

This bylaw is hereby declared to be passed and proclaimed as a bylaw of the Town of Stratford on this 20th day of February, 2019

Witness the corporate seal of the Town.



Mayor



Chief Administrative Officer

This bylaw is hereby declared to be passed and proclaimed as a bylaw of the Town of Stratford

on this 8th day of June, 2019.

Hon. Richard Brown
Minister of Communities, Land and Environment

for/